

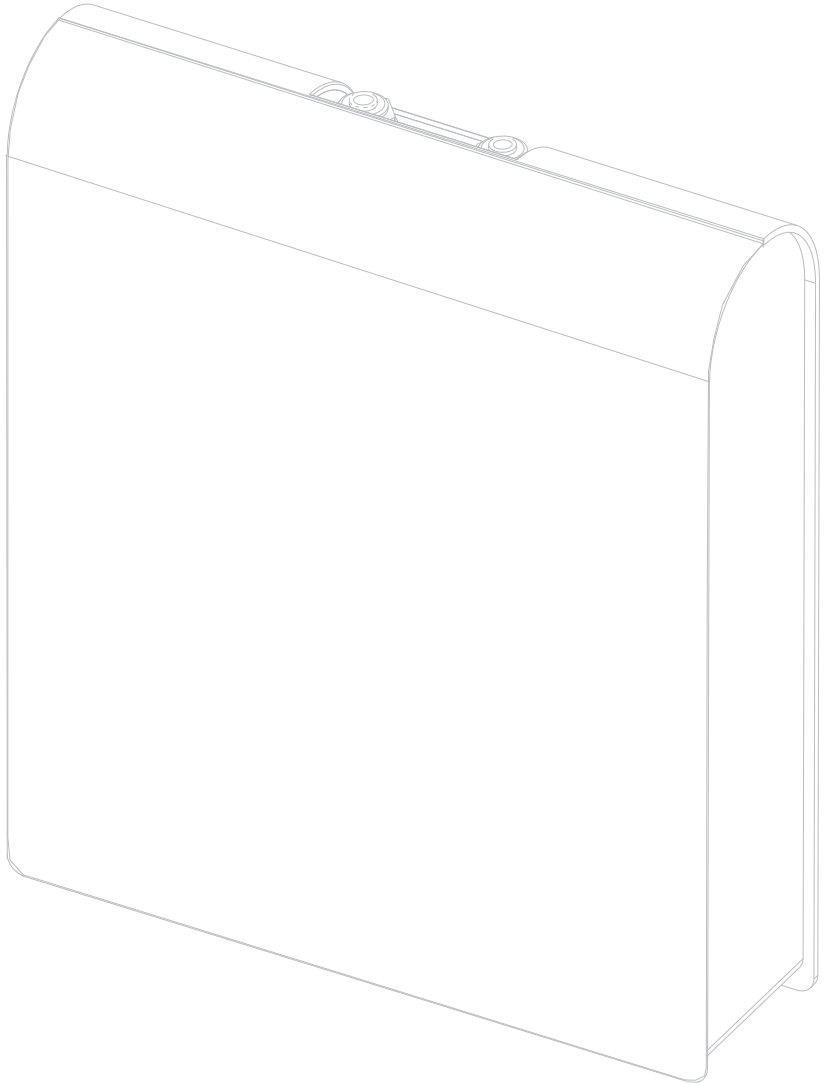

**The Clear Choice**  
Water Filtration Systems



**Installation Manual**

## 1. Safety Precautions

**WARNING! The system should not be used with biologically contaminated water or water of unknown origin.**

**Product may be installed only by trained service professionals. Only original replacement parts, filter cartridges and accessories made by manufacturer may be used.**

Compliance with the following instructions ensures:

- problem free product operation,
- manufacturer's warranty.

Failure to comply with the following instructions will result in loss of warranty.

- 1) Read carefully this Instruction Manual before beginning system installation.
- 2) Check if all elements needed for the installation are included with the system. (refer to point 3 "Included in the Box").
- 3) Please note that after installing the system, as well as after each filter cartridge replacements, and in the case of long inactivity of the system, system flushing procedure must be conducted before resuming system usage.
- 4) After inserting a tubing into a quick connector or a quick connector onto a stub the connected pnce should be secured with a safety clip.
- 5) During disconnecting and connecting of tubing be sure not to break it (correctly installed tubing should be inserted 1.5 cm inside of quick connector).
- 6) Secure quick connector with safety clip after tubing has been inserted.
- 7) For sealing plastic components use only Teflon tape!
- 8) Remember about the right direction of water flow when installing filter cartridges (an arrow marked on a label of each in-line filter cartridge indicates correct water flow).
- 9) During the cartridge installation one must consider water flow direction. An arrow put on each of our inline cartridges indicates water flow direction.
- 10) In all cases of product returns, the system must be returned in its original packaging – otherwise the return will not be accepted.
- 11) Manufacturer is not responsible for any damages resulted from the use of this product if used for other purposes than filtration of potable water.
- 12) Manufacturer does not hold any responsibility for printing errors.
- 13) Manufacturer reserves the right to introduce change or amendments to the provided technical informations at any time and without the necessity of a prior announcement.

Use only genuine **Aqua Market®** and **Aquafilter®** replacement parts, filter cartridges and membrane elements. In case of use of other manufacturers' parts, Aquafilter is not responsible for any damages caused in the course of product use.

## 2. Technical Specifications

Inlet water temperature.....	between 2°C and 45°C
Water supply pressure.....	.6 bar
Water supply adapter.....	1/2"
Outlet tubing.....	1/4"
Dimensions (height x width x depth).....	438 mm x 100 mm x 360 mm

## 3. Included in the Box

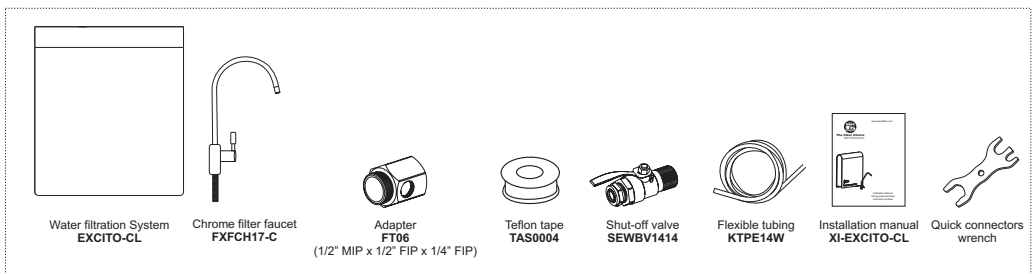

## 4. What is ORP?

**ORP – Oxidation Reduction Potential Potential (ORP)** is a parameter that defines the reaction **REDOX** (reduction reaction - oxidation) for liquids (including water), expressed in mV (millivolts). Redox potential can be measured with **ORP** meter. Readings should be interpreted in the following manner, the lower the ORP, for example: from + 150 mV to - 600 mV, the greater the reduction and oxidation properties.

The higher the rate, the **ORP**, such as: from + 150 mV to + 600 mV, the more oxidized tested liquid is and less effective in scavenging free radicals. **ORP** reading for water provides information about its ability to donate and accept electrons. Water with a low **ORP** is a very effective oxidizer, which naturally drew the free radicals, which are responsible for the formation of cancer cells.

Water with lower ORP, created an alkaline environment, which neutralizes the acidic environment of the body. Hyperacidity is considered as one of the causes of many diseases such as atherosclerosis, and is also responsible for obesity.

## 5. BACinix™ Technology



**BACinix™** is a new innovative formula based on the antimicrobial nanosilver technology. It effectively protects filter cartridges against bacterial flora.

Cartridges are exposed to the risk of bacteria growth on filtration media when water flows slowly through the cartridge, or when water is in contact with filtration media without flow (for a longer period of time).

Maximum lifetime for the inline filter cartridge is a period of up to 6 months. After that period, user should replace the cartridge with a new one (even if the system was rarely used and the filter cartridge continues to work). In such a situation, there is a risk of bacteria growth on the surface and inside the cartridge.

However, **BACinix™** technology prevents the development of bacterial flora and enables the extended usage of the filter cartridge beyond the 6 month period. This way the extended usage time of the filter cartridge is ensured (e.g., in the case where the system is hardly used).

## 6. Connecting Flexible Tubing with Quick Connectors: JG (John Guest) and QC (Quick Connector)

### Disconnect Flexible Tubing:

- 1) Remove safety clip from the quick connector (if applicable) (Fig. 1).
- 2) Press on the flange of quick connector (Fig. 2).
- 3) Pull out flexible tubing (Fig. 3).

### Connect Flexible Tubing:

- 1) Push the flexible tubing 1.5 cm (0.6 in) deep into the quick connector (Fig. 4)
- 2) Insert safety clip (if applicable) (Fig. 5).

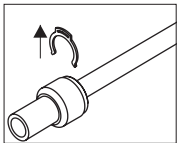

Fig. 1

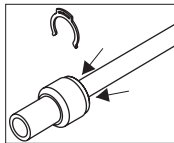

Fig. 2

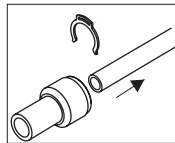

Fig. 3

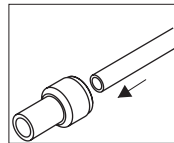

Fig. 4

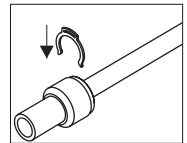

Fig. 5

## 6.1. Instructions for connecting and disconnecting filter cartridge and elbow connector (new filter cartridge with elbow connector)

### Disconnecting elbow connector from filter cartridge:

- 1) Remove safety clips from quick connector (fig.1).
- 2) Push quick connector's flange symmetrically and pull the tubing out (fig. 2).
- 3) Unscrew inlet and outlet connectors from old filter cartridge (fig.3)
- 4) Remove old Teflon tape (fig.4).
- 5) Apply multiply layers of new Teflon tape (ensure that Teflon tape is wound in the opposite direction to the direction connector will be installed) (fig. 5).

### Connecting elbow connector with filter cartridge:

- 1) Screw the elbow connector back to new filter cartridge.

**NOTE! Do NOT remove elbow connector after the installation has been started. Stopping and removing (unscrewing) the element may result in inadequate connection and water leak. (fig.6).**

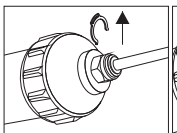

Fig. 1

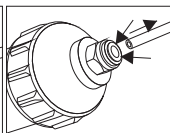

Fig. 2

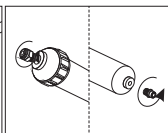

Fig. 3

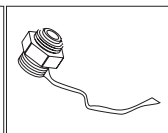

Fig. 4

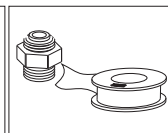

Fig. 5

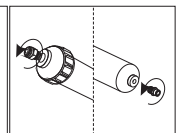
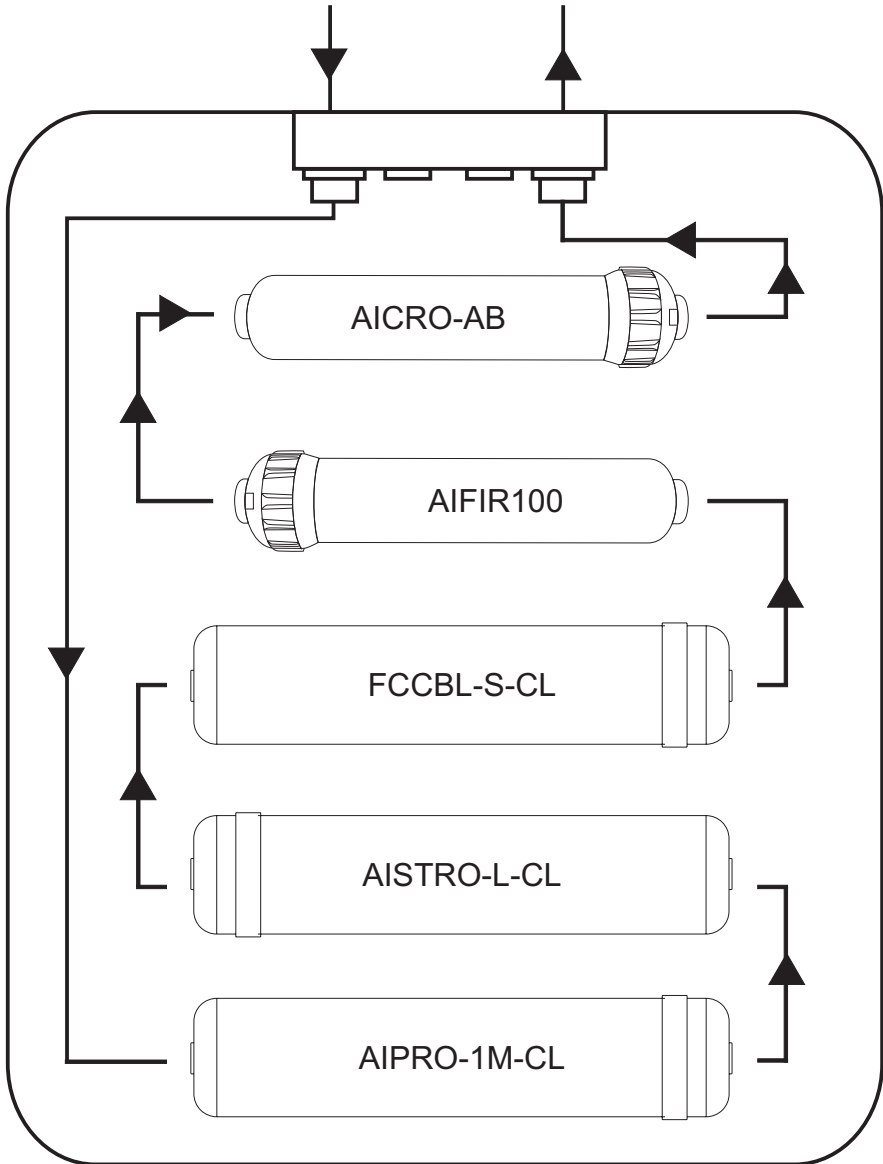

Fig. 6

## 7. Connection diagram



## 8. System Installation - Stage I

**IMPORTANT NOTE!** Manufacturer is not responsible for any damages that result from improper installation or use of system. System installation should be performed only in temperatures above 2°C (35.6°F).

**IMPORTANT NOTE:** Before installing the system, remove from the filter housing all components necessary for installation.

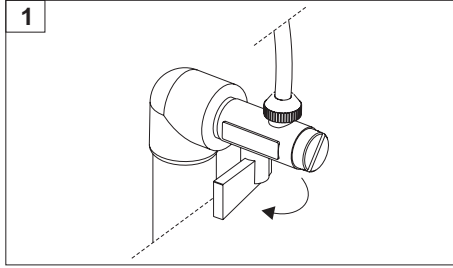

Shut off cold water supply valve.

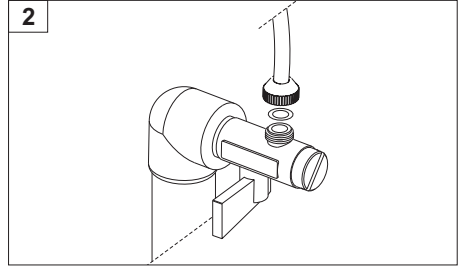

Unscrew flexible tubing from the shut-off valve (the adapter). **IMPORTANT NOTE!** Between the shut-off valve and flexible tubing is a rubber gasket - be sure not to lose it.

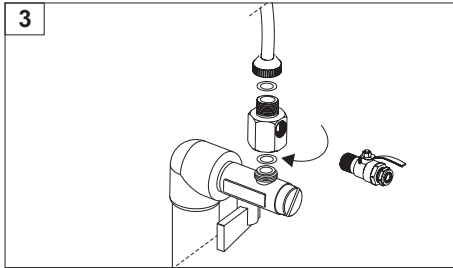

Screw adapter onto the shut-off valve to allow easy installation of **SEWBV1414** valve and its easy opening and closing.

**IMPORTANT NOTE!** Remember to place rubber gaskets in between the connections.

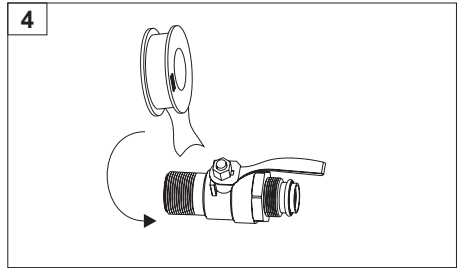

Wind a few layers of Teflon Tape (**TAS0004**) on shut-off valve adapter (**SEWBV1414**).

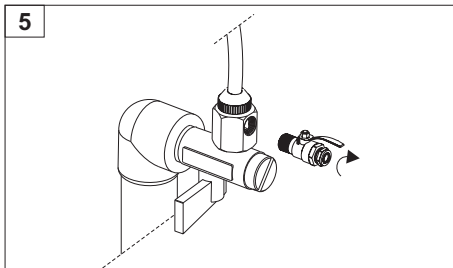

Screw **SEWBV1414** valve into adapter **FT06**.

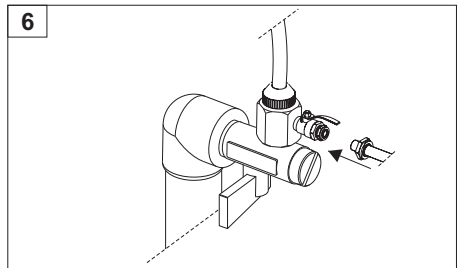

Place the nut on flexible tubing and connect it with **SEWBV1414** valve. Next, push the tubing all the way into the valve and tighten the nut.

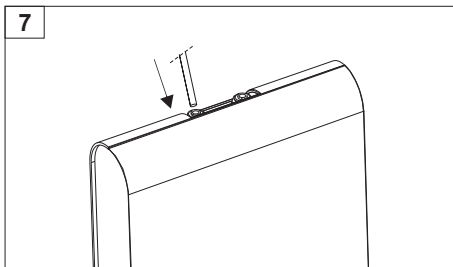

Connect flexible tubing of **SEWBV1414** valve with system's water inlet [IN] (red ring).

## 8. System Installation - Wall Faucet Connection

**IMPORTANT NOTE!** Manufacturer is not responsible for any damages that result from improper installation or use of system. System installation should be performed only in temperatures above 2°C (35.6°F).

**IMPORTANT NOTE:** Before installing the system, remove from the filter housing all components necessary for installation.

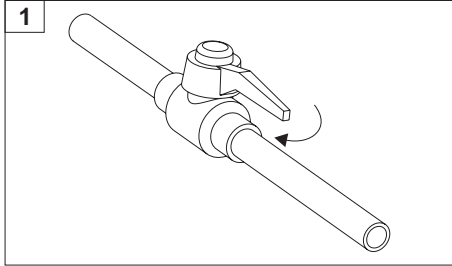

Shut off water supply valve.

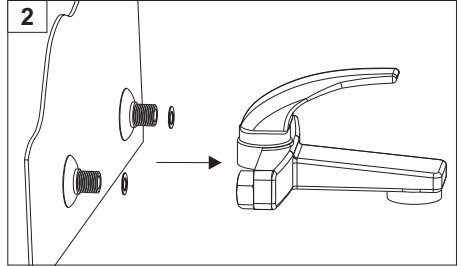

Unscrew the faucet from the wall.

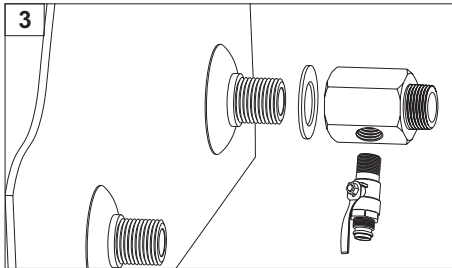

Screw adapter **FT07** onto the cold water pipe to allow easy installation of **SEWBV1414** valve and its easy opening and closing.

**IMPORTANT NOTE!** Remember to place rubber gaskets in between the connections.

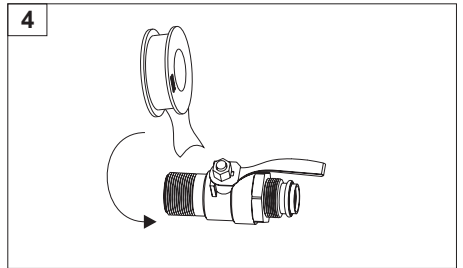

Wind a few layers of Teflon Tape **TAS0004** on shut-off valve adapter **SEWBV 1414**.

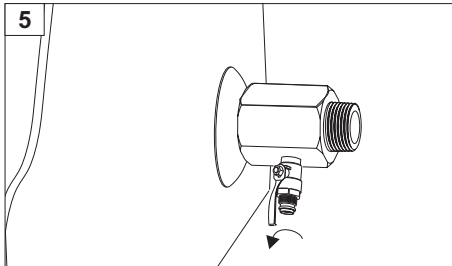

Screw **SEWBV1414** valve into adapter **FT07**.

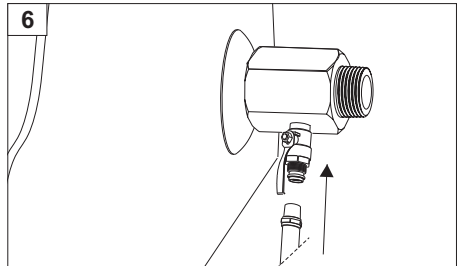

Place the nut on flexible tubing and connect it with **SEWBV1414** valve. Next, push the tubing all the way into the valve and tighten the nut.

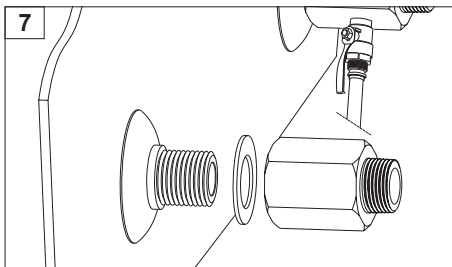

Screw adapter **FT02** onto the hot water pipe. **IMPORTANT NOTE!** Remember to place rubber gaskets in between the connections.

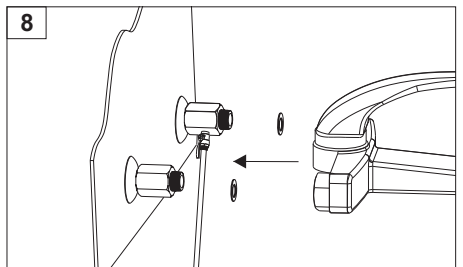

Screw the wall faucet to the installed adapters.

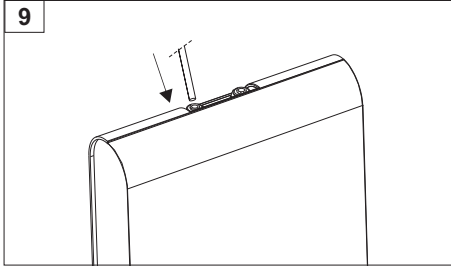

Connect flexible tubing of **SEWBV1414** valve with system's water inlet [IN] (red ring).

## 9. System Installation - Stage II - FXFCH17-C Faucet Installation

- 1) Drill a 12 mm opening in a kitchen counter or kitchen sink (in case of enamel sinks, the manufacturer recommends drilling openings in the structure supporting sink).
- 2) On threaded faucet extension [1], first put on cover plate [2], and then rubber gasket [3].
- 3) Secure the faucet in the drilled sink/counter opening.
- 4) Underneath the sink, put the rubber [5] and metal [6] washers on the faucet extension [4], and tighten with metal nut [7].
- 5) Install flexible tubing (supplying water and connecting faucet with the system):
  - put the tubing [11] through the metal nut [10] and plastic tightening ring [9],
  - put the insert [8] into the tubing,
  - push flexible tubing (all the way) into the faucet extension [4] and tighten it (by hand!) with the metal nut [10].
- 6) Connect other end of flexible tubing with connector [OUT] (white ring) (Fig. 2).

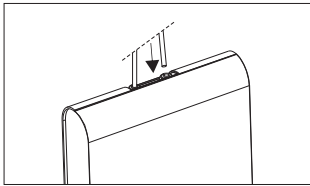

Fig. 2 Connecting flexible tubing with [OUT] connector

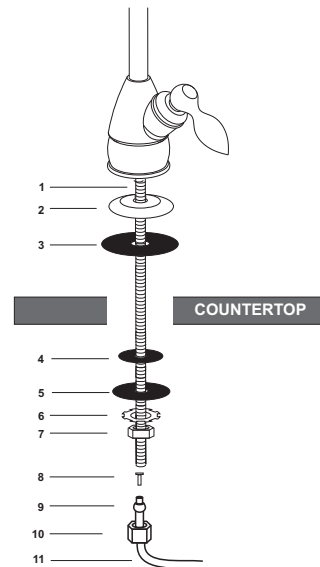

Fig. 1 Installing filter faucet on kitchen counter

## 10. Replacement Cartridges

Cartridge Type	Descriptions	Longevity*
		months
<b>AIPRO-1M-CL</b>	Polypropylene cartridge removes sediments such as rust, sand and suspended solids - 5 micron.	3 - 6
<b>AISTRO-L-CL</b>	In-line water softening filter cartridge, reduces water hardness.	3 - 6
<b>FCCBL-S-CL</b>	In-line carbon block filter cartridge - new generation. Made of a mixture of coconut shell and bituminous carbon (50 - 50%). Additionally, it contains a special filtration media, which reduces the concentration of iron ions, heavy metals, as well as calcium and magnesium ions.	3 - 6
<b>AIFIR-100</b>	In-line filter cartridge with Tourmaline mineral media, lowers water ORP factor to - 150 mV level.	6 - 12
<b>AICRO-AB</b>	In-line coconut shell carbon filter cartridge mixed with non-woven polypropylene fibers made with the application of BACinix™ technology (nano-silver).	6 - 12

\*depends on water quality and level of contamination.

Before the first use and after each cartridge replacement procedure, the system should be flushed with 15 liters of water. Next, allow the system to standby for 5-6 hours to activate the filtration media. After these procedures, the water is ready for consumption.

**IMPORTANT NOTE! Used cartridges may not be returned.**

## 11. Filter cartridge replacement – General information

**IMPORTANT NOTE!** Before removing flexible tubing and elbow, remove safety clip and symmetrically push in the flange of quick connector. After installing flexible tubing and installing the elbow, remember to insert safety clip of the quick connector.

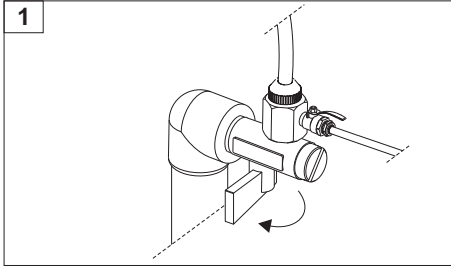

Shut off water supply valve.

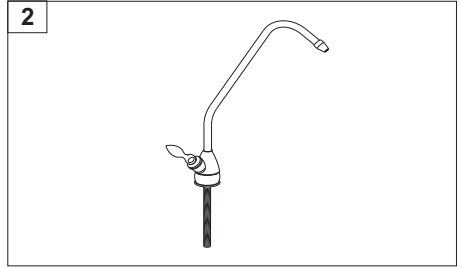

Open filter faucet to release pressure from the system.

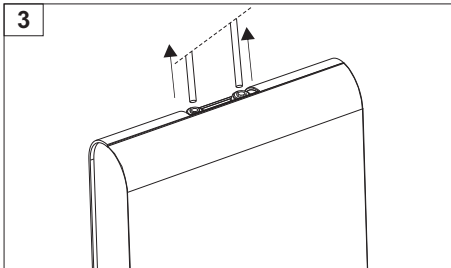

Before replacing the membrane, disconnect all flexible tubing from the system (inlet / outlet).

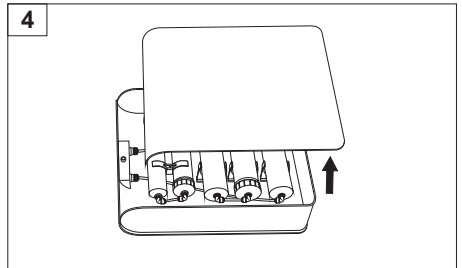

Remove front panel of the system's housing.

### 11.1. Filter cartridge replacement – System equipped with cartridges with regular connectors

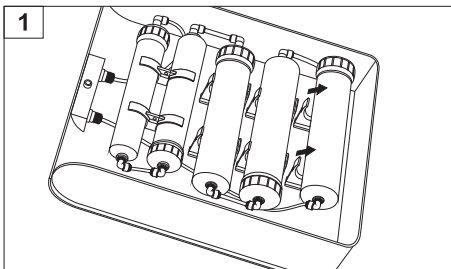

Remove filter cartridge **AIPRO-1M-CL** from mountain brackets.

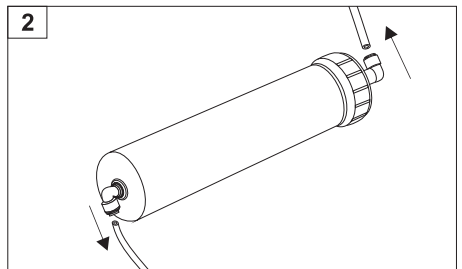

Disconnecting tubing from the inlet elbows of filter cartridge **AIPRO-1M-CL**.

Do the following:

1) Detach the safety clips from elbow inlet and outlet of the cartridge.

2) Press the elbow flange symmetrically.

3) Pull the tubing out.

**NOTE!** The procedure has been described in point. 6.1 on page 4.

**NOTE!** When removing tubing be particularly careful not to bend it. The collapse of the tubing can lead to breakage and water leakage.



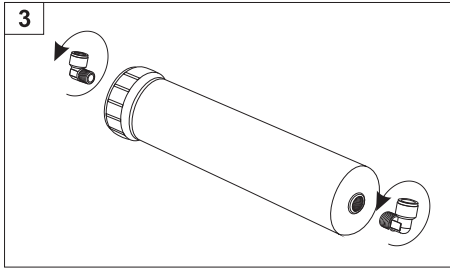

Unscrew inlet and outlet connectors from **AIPRO-1M-CL** filter housing.

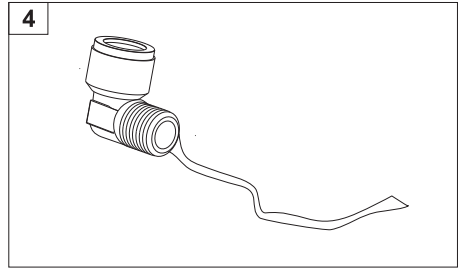

Remove old Teflon tape out of the connectors thread surface.

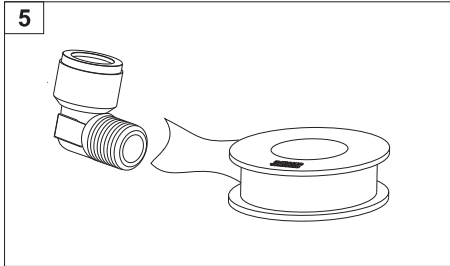

Apply several layers of Teflon tape to the connectors threads.

**NOTE! Use only Teflon tape, do not use tow.**

**NOTE! Apply Teflon tape in the opposite direction to the direction connectors will be installed.**

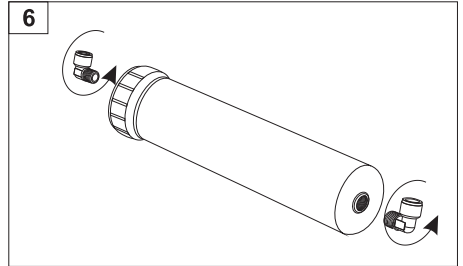

Install (screw in) connectors into new filter cartridge.

**NOTE! During installing (screwing in) individual connectors do NOT withdraw (unscrew) them at any time. This may result in connection damage and future water leaks.**

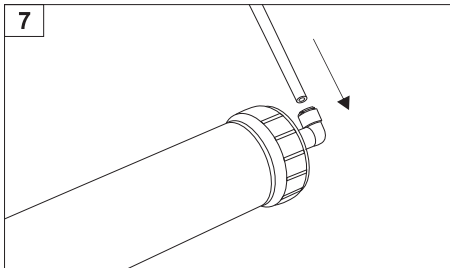

Connecting outlet elbow from filter cartridge **AIPRO-1M-CL** with inlet elbow of filter cartridge **AISTRO-L-CL** using flexible tubing.

**Do the following:**

- 1) Make sure that the input will be connected in the direction of water flow. The correct water flow direction is indicated by arrows placed on the label of each filter cartridge.
- 2) Push-in tubing into the output elbows attached to filter cartridge **AIPRO-1M-CL** (properly inserted tubing sets in about 1.5 cm).
- 3) Secure the connection with safety clip.

NOTE! The procedure have been described in point. 6.1 on page 4.

**NOTE! When inserting the tubing be particularly careful not to bend it. The collapse of the tubing can lead to breakage and water leakage.**

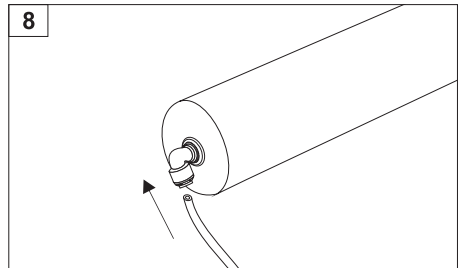

Connecting input elbow from filter cartridge **AIPRO-1M-CL** with water supply using tubing.

**Do the following:**

- 1) Make sure that the filter cartridge is installed correctly in the same direction as water flow. Water flow direction is marked with arrow on the product label.
- 2) Push the inlet tubing into the elbow connector, attached to the **AIPRO-1M-CL** filter cartridges (properly inserted tubing sets in about 1.5 cm.)
- 3) Secure the connection with safety clip.

NOTE! The procedure have been described in point. 6.1 on page 4.

**NOTE! When inserting the tubing be particularly careful not to bend it. The collapse of the tubing can lead to breakage and water leak.**

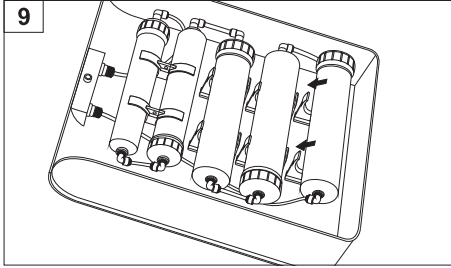

Insert filter cartridge into mounting brackets.

**To replace the remaining filter cartridges follow instruction described by points 1-9.**

**NOTE! After each replacement cartridge, you must pass 15 liters of water through the system. After completing the above-mentioned procedures, filter water can be consumed.**